



P.O. Box 8276, Fort Worth, TX 76124, 817/429-6666

**UNIVERSAL BAR FOR A SINGLE DOOR
MODEL # SB-01-UV48**

CONTENTS

| | | |
|----|---------------------|---|
| 1 | ELEVATOR BOLT | 4 |
| 2 | SHORT BAR | 2 |
| 3 | "L" BOLT | 2 |
| 4 | PLASTIC CAP (SMALL) | 4 |
| 5 | STEP NUT | 4 |
| 6 | FLANGE NUT | 4 |
| 7 | PLASTIC CAP (LARGE) | 2 |
| 8 | LONG BAR | 1 |
| 9 | PLASTIC CAP (RED) | 2 |
| 10 | LIQUID STEEL GRIP | 1 |
| 11 | "U" SHAPED TEMPLATE | 1 |

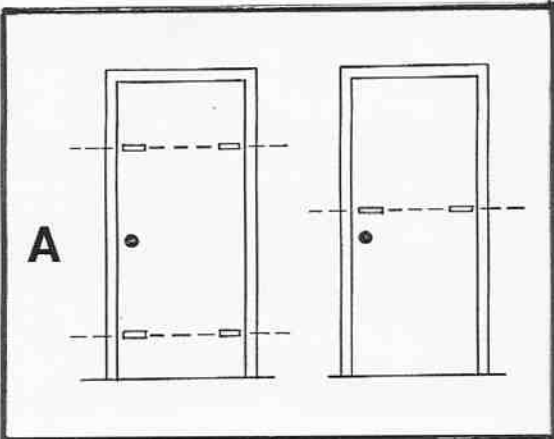
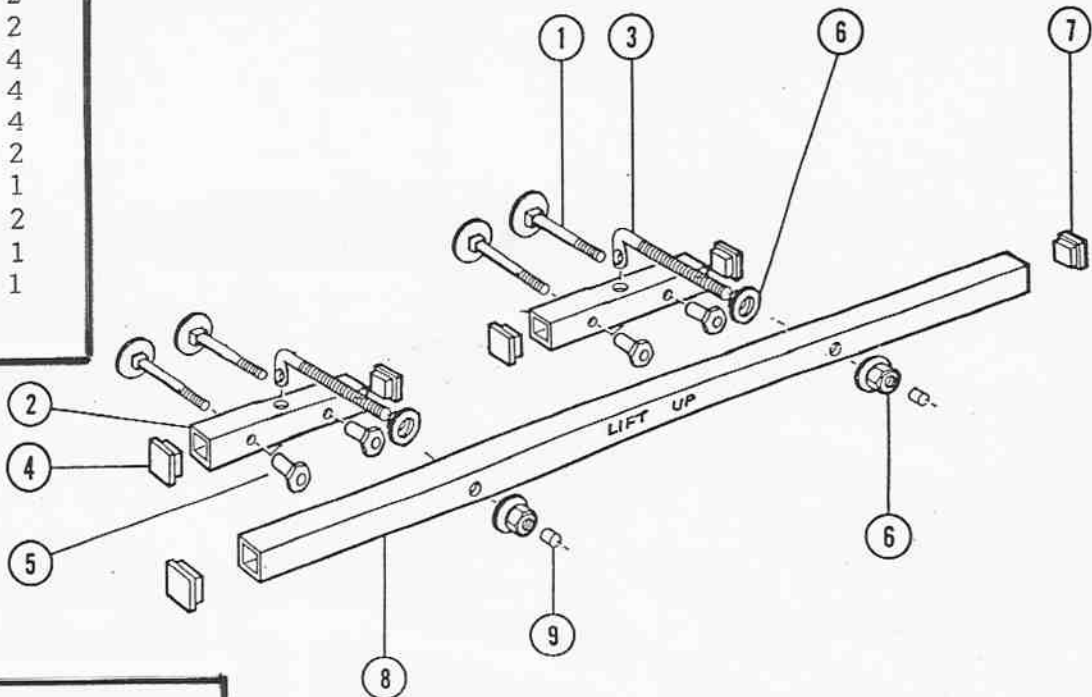

1. LOCATE HORIZONTAL LINE WHERE BARS ARE TO BE INSTALLED. IF YOU HAVE PURCHASED TWO UNITS YOU WILL WANT THE 1" BARS APPROXIMATELY 18" UP FROM THE FLOOR AND DOWN FROM THE HEADER.
(SEE FIGURE A. AND B.)

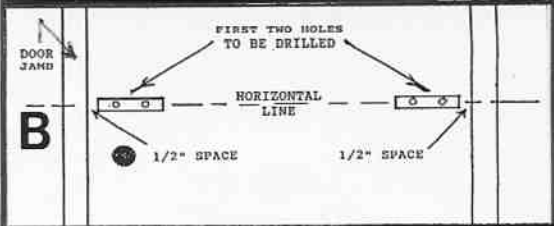

2. HOLD THE SHORT BARS AGAINST DOOR AND ON THE HORIZONTAL LINE WHILE YOU MARK THE TWO POINTS AS ILLUSTRATED.
(SEE FIGURE B. AND C.)

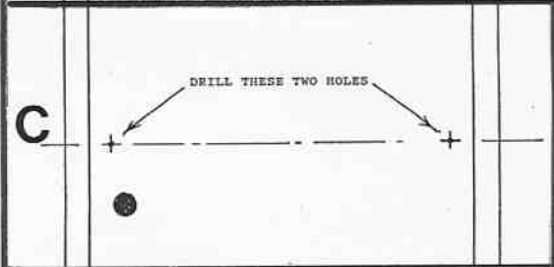

3. USING THE MARKS AS THE CENTERS, DRILL A HOLE (5/16" DIAMETER) COMPLETELY THROUGH THE DOOR.
REMEMBER: ALWAYS KEEP THE DRILL PERPENDICULAR TO THE PLANE OF THE DOOR.
(SEE FIGURE C.)

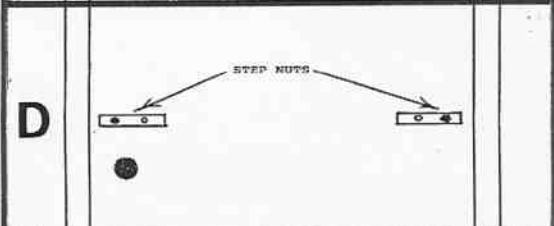

4. INSTALL SHORT BARS WITH ELEVATOR BOLTS AND STEP NUTS.
(SEE FIGURES D., F. AND G.)

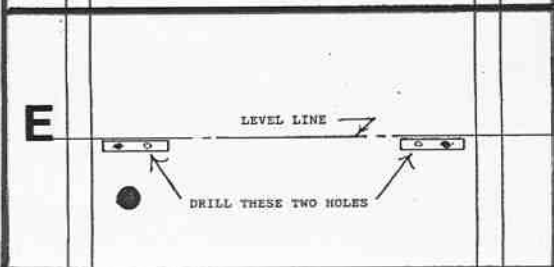

5. POSITION SHORT BARS ON A LEVEL LINE USING A CARPENTER'S LEVEL, THEN TIGHTEN NUTS FIRMLY. NOW, USING THE SHORT BAR AS A DRILL FIXTURE, DRILL THE REMAINING TWO HOLES THROUGH THE SHORT BAR AND THEN THROUGH THE DOOR WITH A 5/16" DRILL BIT.
(SEE FIGURE E.)

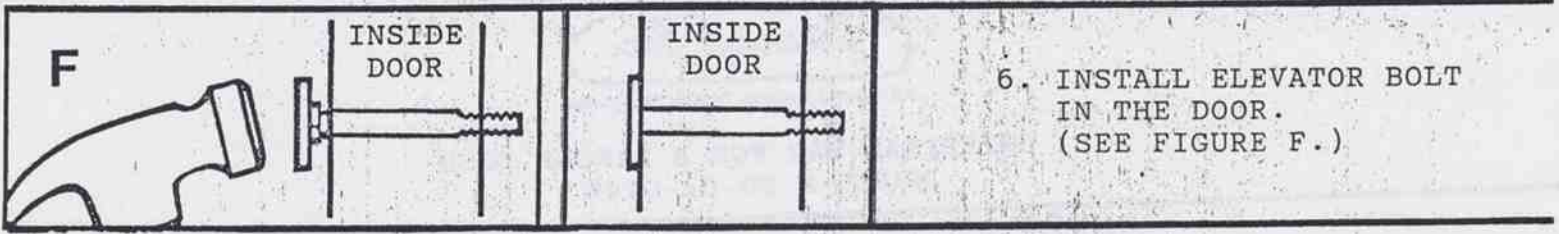

6. INSTALL ELEVATOR BOLT IN THE DOOR. (SEE FIGURE F.)

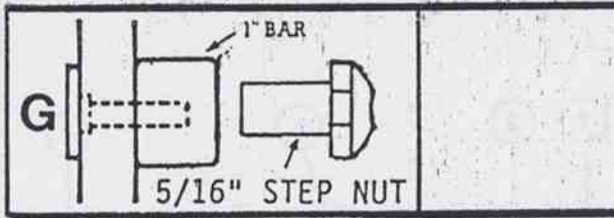

7. INSTALL STEP NUT. (SEE FIGURE G.)

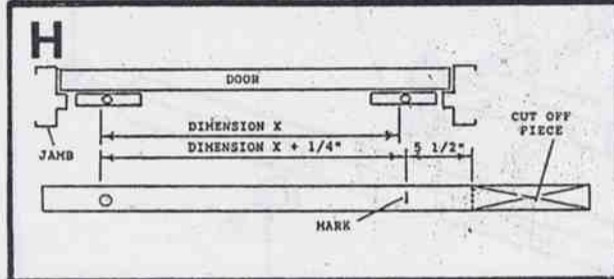

8. ACCURATELY MEASURE THE DISTANCE FROM ONE HOLE ON THE SHORT BAR TO THE NEXT. TAKE THIS DIMENSION AND ADD 1/4" AND MAKE A MARK. ADDING 5 1/2" TO THIS GIVES YOU THE LOCATION TO CUT OFF BAR. DEBUR AND INSTALL PLASTIC END CAP. (SEE FIGURE H.)

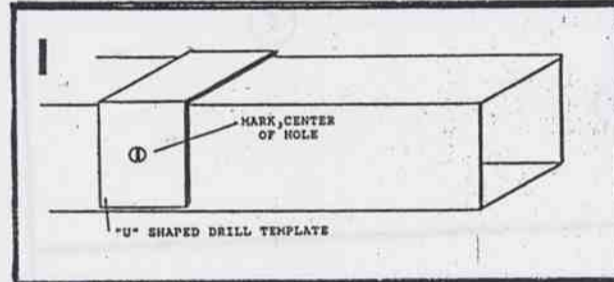

9. PLACE "U" SHAPED TEMPLATE ON BAR ALLOWING YOUR MARK TO SHOW THROUGH THE CENTER OF THE TEMPLATE HOLE. (SEE FIGURE I.)

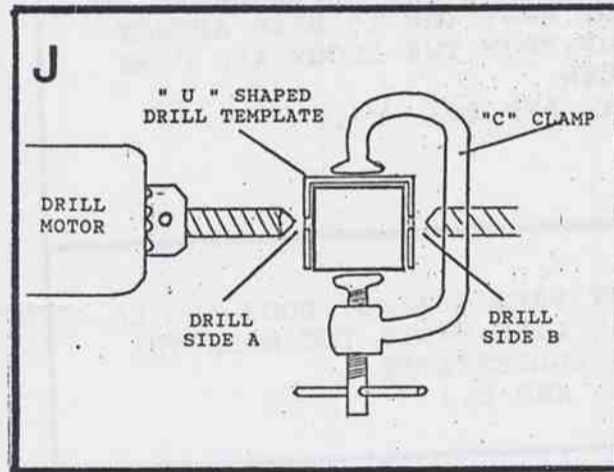

10. YOU HAVE TWO CHOICES: EITHER USE THE TEMPLATE TO MARK HOLE LOCATIONS OR USE AS A DRILL FIXTURE.
 10a. MARK HOLES, USE A CENTER PUNCH AND DRILL A 1/2" DIAMETER HOLE THROUGH SIDE A AND THEN SIDE B.
 10b. HOLD TEMPLATE FIRMLY IN POSITION WITH "C" CLAMP. NOTICE THAT THE TEMPLATE HOLE IS SMALLER THAN 1/2". DRILL THROUGH TEMPLATE AND THROUGH SIDE A THEN SIDE B. (SEE FIGURE J.)

Installation of 1/4" bar assembly

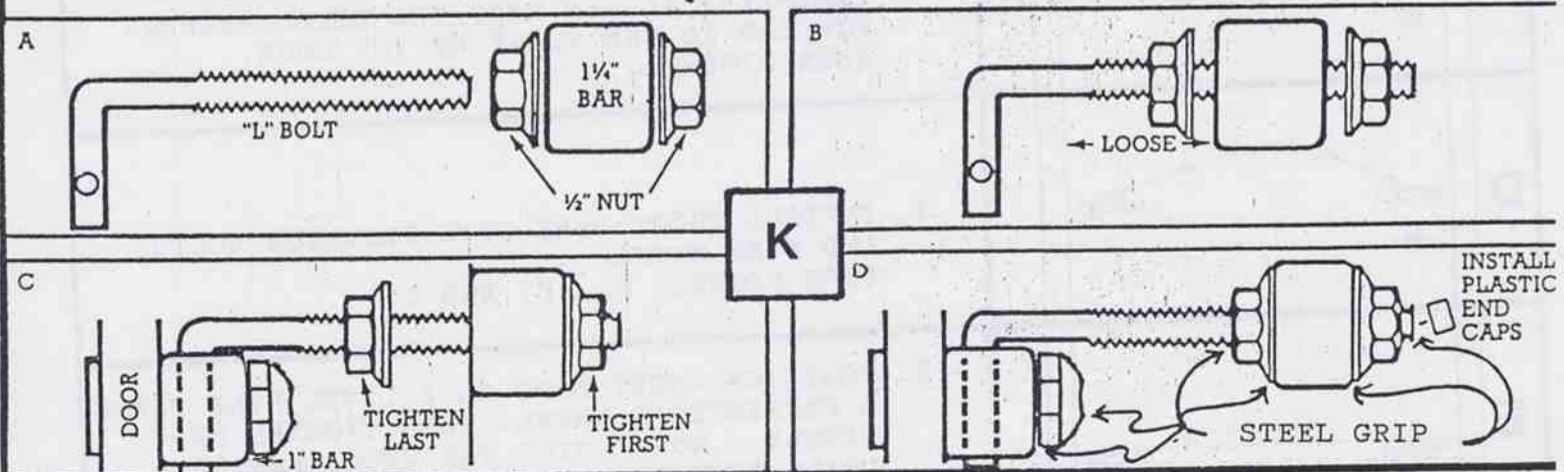

11. Remove the 1/4" bar assembly and replace it several times, adjusting the two nuts as necessary to make a perfect fit. Tighten both nuts firmly. Only after final tightening should you apply 2 drops of Loctite at each point as shown in drawing "K". STEEL GRIP has a wicking characteristic, therefore do not loosen nuts. And last, install 1/2" plastic caps on ends of bolts.